



# Standard Elbows

11 Gauge Elbows Available / 30° and 60° Elbows Available

## STANDARD ELBOWS

### STANDARD RADIUS ELBOWS

A(OD)	B(CLR)	45° PART NO.	C	TAN.	90° PART NO.	C	GAUGE
2-1/8"	5"	EL-211	4-5/16"	2"	EL-212	7"	16
2-1/2"	6"	EL-251	4-1/2"	2"	EL-252	8"	16
3"	7-1/2"	EL-301	5-1/8"	2"	EL-302	9-1/2"	16
3-1/2"	8-3/4"	EL-351	5-5/8"	2"	EL-352	10-1/4"	16
4"	10"	EL-401	6-1/8"	2"	EL-402	12"	16
5"	12-1/2"	EL-501	7-13/16"	2-5/8"	EL-502	15-1/8"	14
6"	15"	EL-601	9-15/32"	3-1/4"	EL-602	18-1/4"	14
8"	20"	EL-801	12-17/32"	4-1/4"	EL-802	24-1/4"	14
10"	32"	EL-1001*	28-1/4"	15"	EL-1002*	47"	12
12"	36"	EL-1201**	21-5/32"	6-1/4"	EL-1202**	42-1/4"	12
14"	36"	EL-1401**	22-5/32"	7-1/4"	EL-1402**	43-1/4"	12

\* Stainless Parts are Segmented

\*\* Segmented

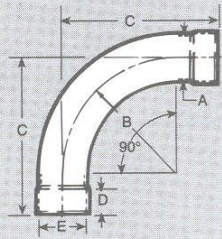
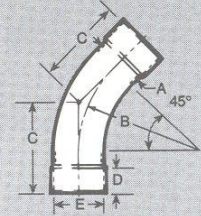

### SHORT RADIUS ELBOWS

A(OD)	B(CLR)	45° PART NO.	C	TAN.	90° PART NO.	C	GAUGE
2-1/8"	3-1/2"	SR-211	3-7/16"	2"	SR-212	5-1/2"	16
2-1/2"	4"	SR-251	3-21/32"	2"	SR-252	6"	16
3"	4-1/2"	SR-341	3-7/8"	2"	SR-342	6-1/2"	16
3-1/2"	5"	SR-351	4-1/16"	2"	SR-352	7"	16
4"	6"	SR-441	4-1/2"	2"	SR-442	8"	16
5"	7-1/2"	SR-541	5-23/32"	2-5/8"	SR-542	10-1/8"	14
6"	9"	SR-641	6-31/32"	3-1/4"	SR-642	12-1/4"	14
8"	12"	SR-841	9-7/32"	4-1/4"	SR-842	16-1/4"	14

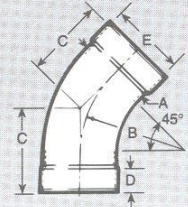

D Expansion Depth 1-1/4" thru 4" OD, 1-1/2" for 5" and 6" OD

E Inside Diameter (ID) = A Outside Diameter (OD)

CLR = Center Line Radius

TAN. = Tangent Length

All reference dimensions are nominal.

Catalog Part Variations Available Upon Request.

**Expanded Ends standard through 6" size, also available Expanded One End.**

**Straight Ends available on all sizes by request.**

**NOTE: FOR LONG RADIUS BENDS SEE PAGE 15.**

